

## ELECTRICAL GAUGES W/WARNING

SMOKE LENS & ANGEL RING GAUGE SUPER WHITE LED DISPLAY

### Tachometer

### OPENING CEREMONY

#### 1 CYLINDER SELECTION SWITCH [BACK VIEW]

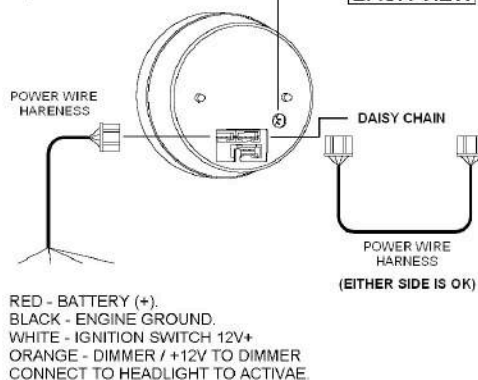

#### 2

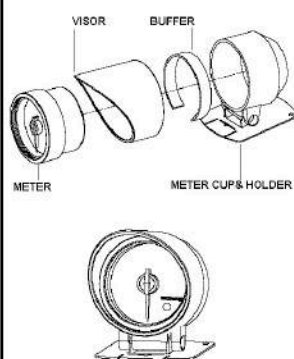

#### 3

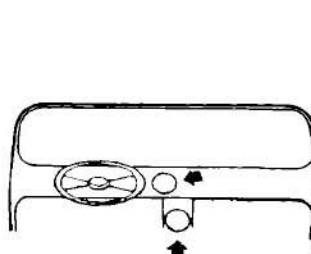

#### 4

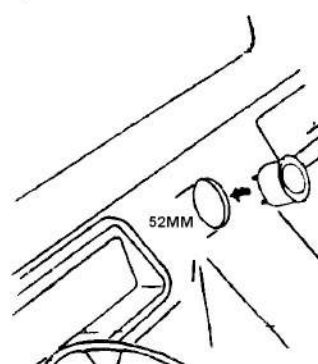

#### 5

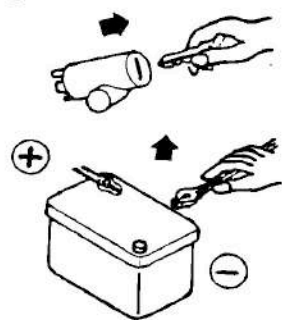

#### 6

\*\* The warning is tachometer exceed 6000RPM.

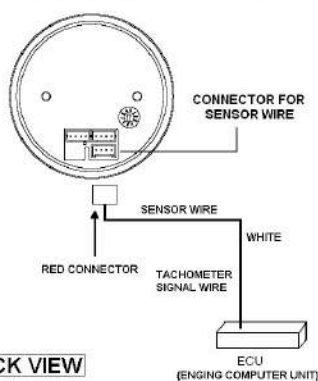

#### 7

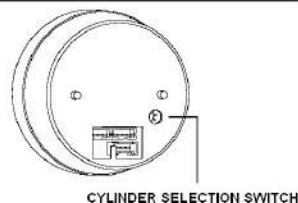

1. Selecting Number of Cylinders:  
Setting the tachometer for 4, 6 or 8 (4, 6 or 3) cylinder operation is achieved simply by sliding the switch, located on back of the tachometer body, to coincide with the appropriate number of cylinders of the engine.
2. Switch position:  
0=10 cylinders, 1=1 cylinders, 2=2 cylinders  
3=3 cylinders, 4=4 cylinders, 5=cylinders.....
3. When setting the number of cylinders for a rotary engine, set the cylinders number selection to 4 cylinders for 2 rotors, and to 6 cylinders for 3 rotors.
4. The red or black wire MUST be removed before adjustment to the cylinder setting is made from the cylinder selector switch.

#### 8

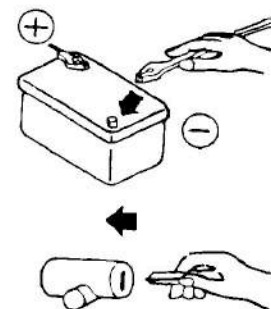

### Voltmeter

### OPENING CEREMONY

#### 1 [BACK VIEW]

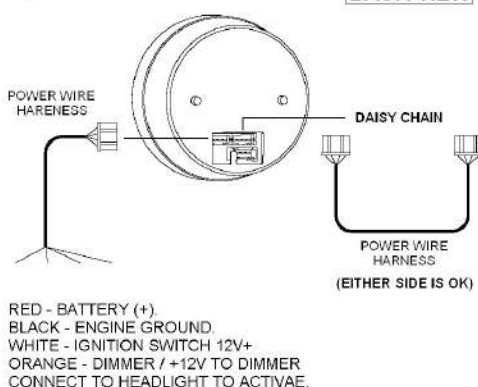

#### 2

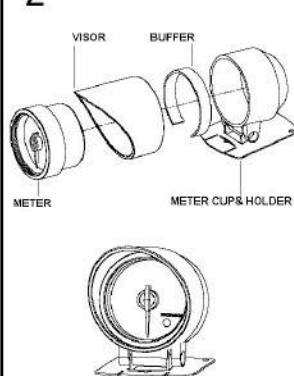

#### 3

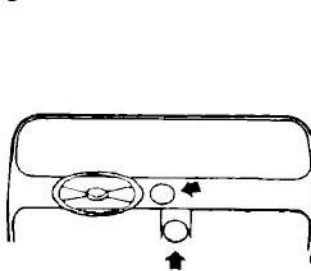

#### 4

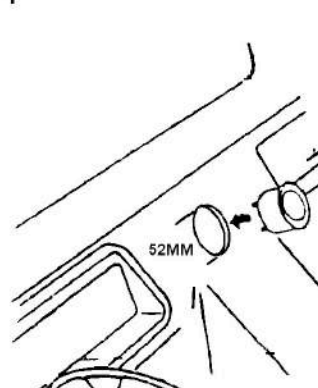

#### 5

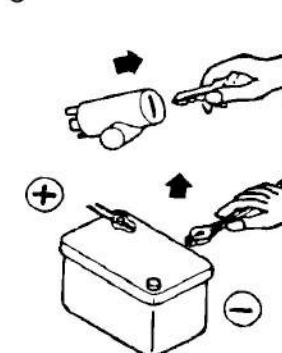

#### 6

\*\*The warning is voltage lower 11.5V.

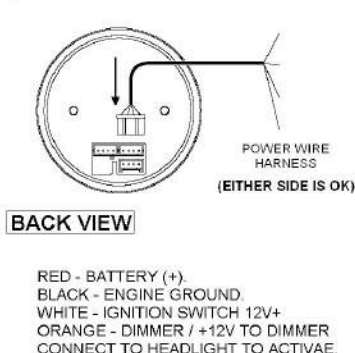

#### 7

