

ELECTRICAL GAUGES

Daytona Vintage Series AMBER RED & SUPER WHITE LED DISPLAY

(270° SCALE)

Tachometer

AUTO CALIBRATION

1

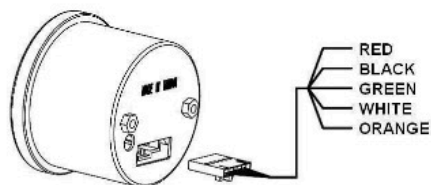

RED - TO IGNITION SWITCH 12V(+)
 BLACK - BATTERY (-)
 GREEN - ON STANDARD IGNITION GREEN WIRE ATTACHES TO COIL NEGATIVE (-)
 WHITE - NOTE
 ORANGE - NOTE

2

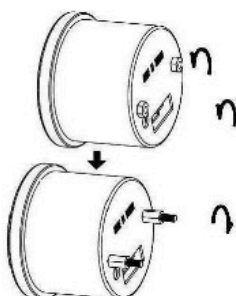

3

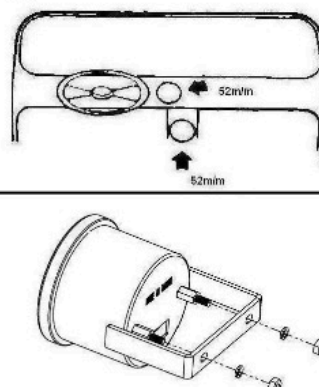

4

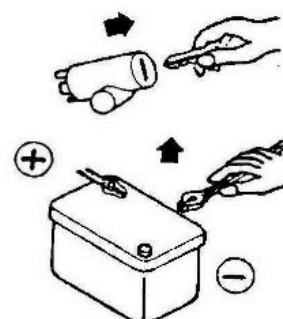

5

CYLINDER SELECTION SWITCH



1. Selecting Number of Cylinders:
 Setting the tach for 4, 6 or 8 (4, 6 or 8) cylinder operation is achieved simply by sliding the switch, located on back of the tachometer body, to coincide with the appropriate number of cylinders of the engine.
 2. Switch position:
 0=10 cylinders, 1=1 cylinders, 2=2 cylinders
 3=3 cylinders, 4=4 cylinders, 5=cylinders,
 3. When setting the number of cylinders for a rotary engine, set the cylinders number selection to 4 cylinders for 2 rotors, and to 6 cylinders for 3 rotors.
 4. The red or black wire MUST be removed before adjustment to the cylinder setting is made from the cylinder selector switch.

6

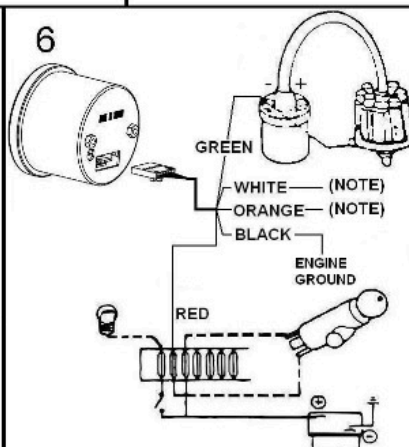

7

NOTE : GAUGE REQUIRE FUNCTION

Lighting Diagram

Day Time	Night Time	Installation
White	White	White - Connect to acc. Power Orange - Do not connect
Amber	Amber	Orange - Connect to acc. Power White - Do not connect
White	Amber	White - Connect to acc. Power Orange - connect to parking lamp
Amber	White	Orange - Connect to acc. Power White - connect to parking lamp

8

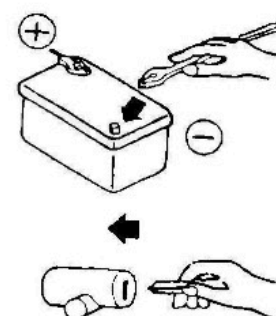

Voltmeter

AUTO CALIBRATION

1

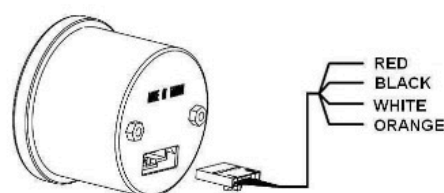

RED - TO IGNITION SWITCH 12V(+)
 BLACK - BATTERY (-)
 WHITE - NOTE
 ORANGE - NOTE

2

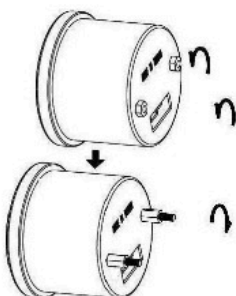

3

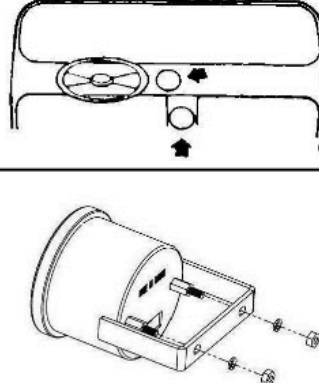

4

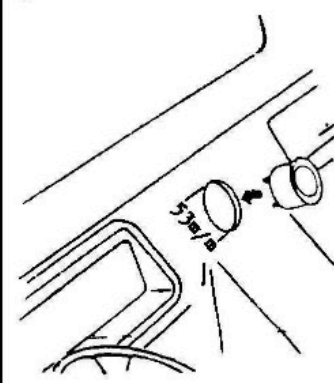

5

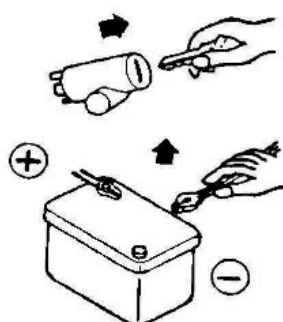

6

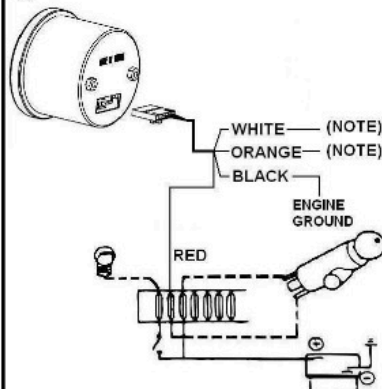

7

NOTE : GAUGE REQUIRE FUNCTION

Lighting Diagram

Day Time	Night Time	Installation
White	White	White - Connect to acc. Power Orange - Do not connect
Amber	Amber	Orange - Connect to acc. Power White - Do not connect
White	Amber	White - Connect to acc. Power Orange - connect to parking lamp
Amber	White	Orange - Connect to acc. Power White - connect to parking lamp

8

