

ELECTRICAL GAUGES w/PEAK & WARNING

52mm PREMIUM SERIES WHITE / AMBER LED DISPLAY

Fuel Press Gauge

OPENING CEREMONY

1

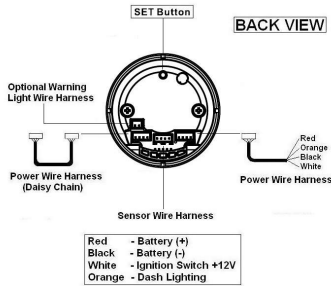

2

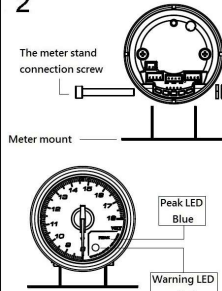

3

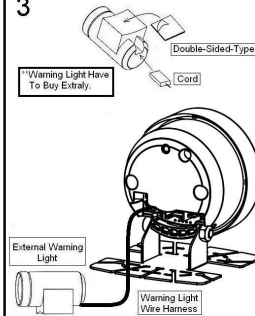

4

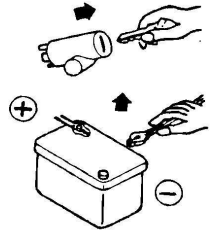

5

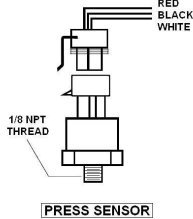

6

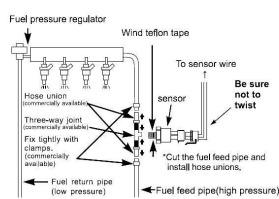

7

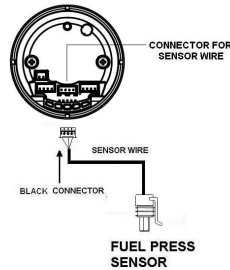

8

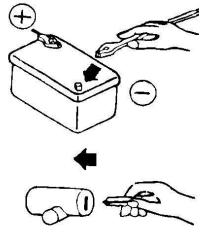

Exhaust Gas Temperature Gauge

OPENING CEREMONY

1

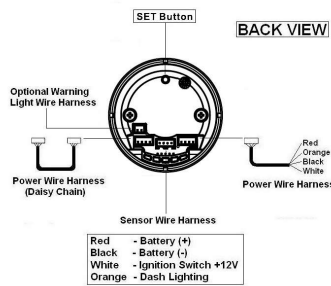

2

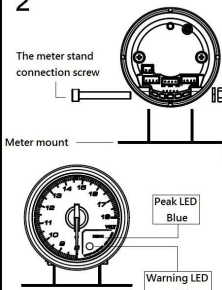

3

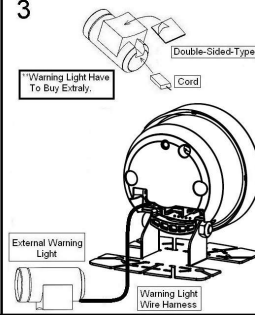

4

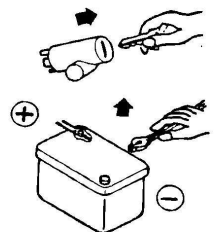

5

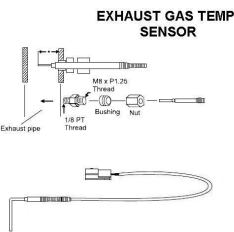

6

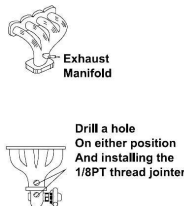

7

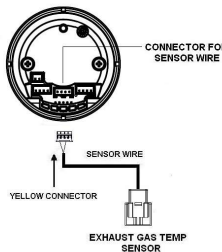

8

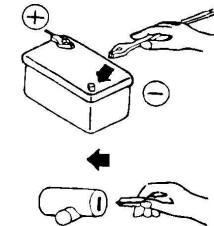

OPERATING INSTRUCTION

WARNING: IT IS DANGEROUS TO OPERATE THE SETTING OF THE GAUGE WHEN YOU ARE DRIVING, CONSIDERING YOUR AND OTHERS SAFETY, PLEASE OPERATE THE SETTING BEFORE DRIVING.

Selectable Brightness Levels

Two colors available: Amber / White. Both have six stages of brightness level.

The Premium Gauge Series selectable brightness settings for both day and night lighting modes. Below are the instructions on how to program each lighting mode.

Day mode

- Press the button located on back of the gauge to adjust backlight.
- Press the button to cycle through the 12 dimming modes.
- Once you selected your ideal setting release the button and the gauge will save your selection.

Night mode

- This mode is only available if the orange dimmer wire is connected and your headlights are powered.
- Press the button to cycle through the 12 dimming modes.
- Once you selected your ideal setting release the button and the gauge will save your selection.

Peak Mode

- 1.) Hold the button for 3 seconds to enter peak mode and the "PEAK" light will come on. The pointer will rise to the highest level attained by the gauge and remain there approximately 5 seconds.
- 2.) To reset peak level: Hold the button while in peak mode ("PEAK" light is on).
- 3.) The gauge will back to normal mode after 5 seconds inactivity.

Warning Settlement

Hold the button for 5 seconds until the pointer begins to blink. Push and hold the button to move across the scale or toggle button to move pointer in small increment. Once you have the pointer you want, then wait 5 seconds and pointer will stop blinking.

Mute Feature

- 1.) With ignition key in off position, hold the button – Turn ignition on, wait for pointer to come to a rest then release button.
- 2.) To turn sound on – Repeat step 1.